

# Fire Protection Collection

working around the clock and around the world,  
stopping false fire alarms, vandalism, and theft



*"We protect the things that protect you."*



**Safety Technology International, Inc.**



STI-1100



This unique and patented device has been helping stop false fire alarms around the world for more than 20 years, without restricting legitimate alarms. It is ideal for schools, colleges, hospitals, nursing homes, stores, hotels and public buildings of almost every kind where there is a threat of false fire alarms.

Stopper II consists of a clear, tamper-proof, super tough polycarbonate shield and frame that fits over manual pull stations. When lifted to gain access to the actual alarm, it sounds a piercing 120 dB or 100 dB warning horn. Immediate attention is drawn to the area and a prankster will either run or be caught.

## FEATURES

- Proven effective for more than 20 years in helping stop false fire alarms without restricting legitimate alarms.
- Unconditional lifetime guarantee of the molded polycarbonate cover against breakage and damage.
- Can be used as a guard against physical damage to a manual pull station, with or without the optional warning horn.
- Fits virtually all manual pull stations.
- Available in red, blue, green or yellow with custom labeling.
- Larger sizes and surface mounted pull stations accommodated with STI-3100 conduit spacer.
- Weather resistant gaskets available. UL requires stations to be listed for outdoor use with cover. (See STI-1250 spec sheet).
- Cover is UV-stabilized against sun deterioration.
- Tested and accepted by fire prevention authorities and approved by testing organizations.
- Power source is 9 VDC alkaline battery on standard Stopper II. (Remote powered unit is available).
- Optional horn has choice of 100 dB or 120 dB.
- Polycarbonate tested -40°F (-40°C) to 120°F (49°C).

## Dimensions and Technical Information

Models Available

- STI-1100** With horn for flush mounting.
- STI-1130** With horn and conduit spacer for surface mounting.
- STI-1200** Without horn for flush mounting.
- STI-1230** Without horn, shipped with conduit spacer for surface mounting.
- STI-1100R\*** For flush mounting with 24 VDC remote powered horn.
- STI-1130R\*** Surface mounted version of the STI-1100R. Includes conduit spacer.
- STI-1100C9\*** With battery powered horn and relay trigger for flush mounting.
- STI-1130C9\*** Surface mounted version of the STI-1100C9. Includes conduit spacer.
- STI-1100RC\*** With 24 VDC remote powered horn and relay contacts for flush mounting.
- STI 1130RC\*** Surface mounted version of the STI-1100RC. Includes conduit spacer.

\*These models not tested with UL or other listing agencies.

**NOTE:** For weather resistant models, please refer to STI Weather Stopper. (STI-1250)

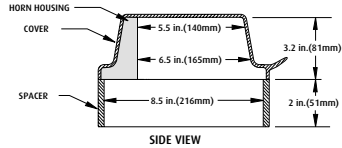

MODELS WITH HORN (STI-1100 Series)

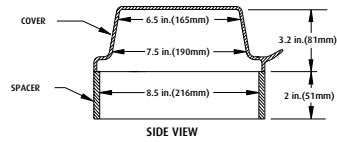

MODELS WITHOUT HORN (STI-1200 & STI-3150 Series)

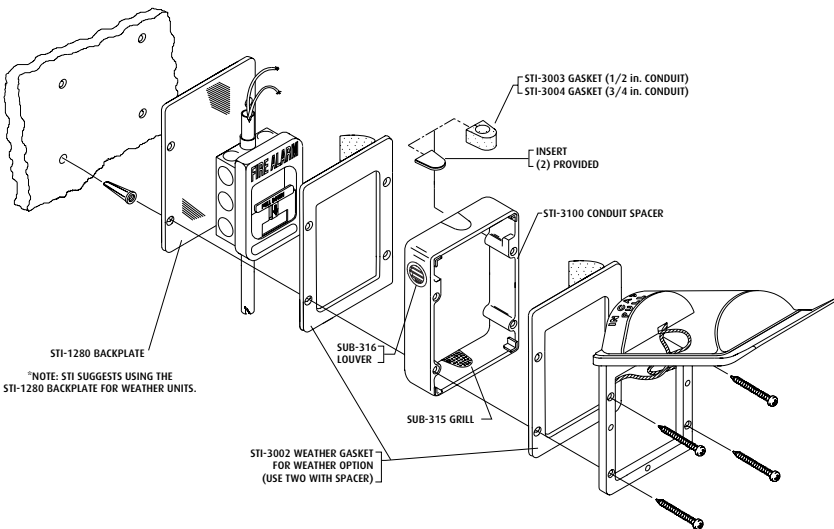
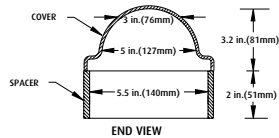



STI-3150

This tough, clear polycarbonate cover helps dramatically to extend the life and reliability of weather exposed manual pull stations, push buttons and similar devices as well as protect them in harsh indoor conditions. Using the same super tough cover as the Stopper® II device but without the warning horn, it is especially useful in increasing the lifespan of units in saltwater areas or other severe environments. Two versions are offered: STI-1250 for flush

mounted stations and STI-3150 for surface mounted units.

Because this strong, durable cover can take the toughest knocks, it also guards against physical damage and thereby helps reduce false fire alarms. It is UV-stabilized against discoloration and in addition protects against damage from dust and grime. Weather Stopper carries a lifetime guarantee against breakage in normal use.

## FEATURES

- Molded of thick, super tough polycarbonate material.
- Protection against physical damage, dust, grime, and severe environments inside and out.
- Serves as an inexpensive weather cover as well as helps stop vandalism and accidental damage.
- Fast, easy installation.
- Widely used to extend the life of equipment in saltwater areas such as aboard oceangoing ships, on oil rigs or at beachfront condos.
- UV-stabilized against sun deterioration.
- When used outdoors, can pay for itself many times over. (UL requires pull stations to be listed for outdoor use with cover).
- Available in red, blue, green and yellow with custom labeling.
- UL tested to NEMA 3R requirements for weather rating for moisture resistance.
- Lifetime guarantee against breakage and damage in normal usage.
- Polycarbonate tested -40°F (-40°C) to 120°F (49°C).

## Dimensions and Technical Information

Models Available

**STI-1250** Without warning horn for flush mount manual pull stations. Includes weather gasket.

**STI-3150** Without warning horn for surface mount manual pull stations (those with exposed conduit). Includes two weather gaskets and a conduit spacer.

**Note:** Smaller models are available. Please see Mini Stopper data sheet.

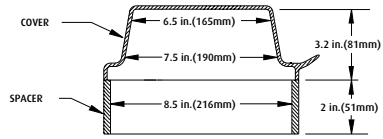
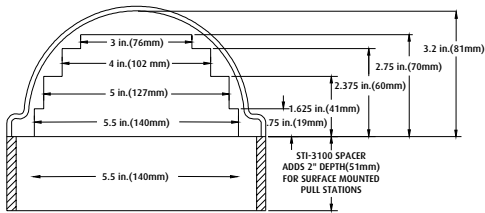

MODELS WITHOUT HORN (STI-1200 & STI-3150 Series)

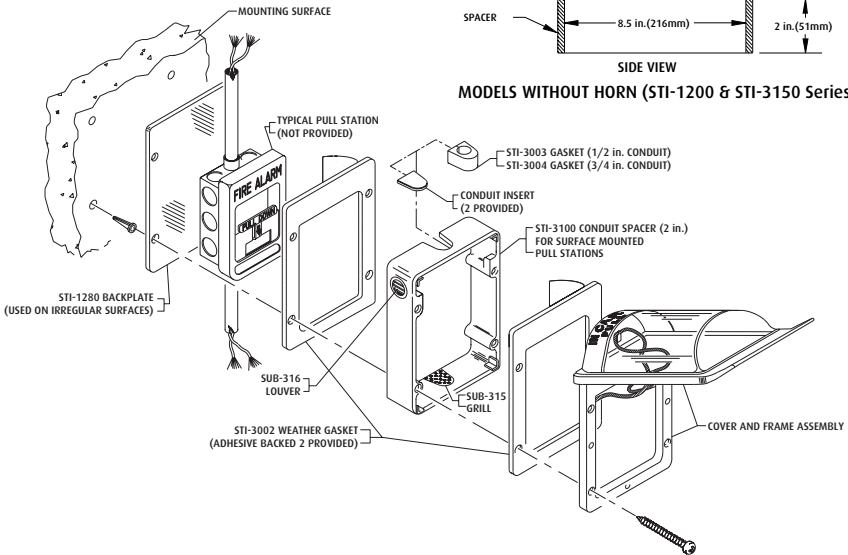

# Mini Stopper® Mini Weather Stopper®



STI-6535



STI-6500



STI-6525 and  
STI-6535 only

**MEA**  
STI-6500 and  
STI-6505 only



This unique device has been helping stop false fire alarms around the world for decades, without restricting legitimate operation of devices such as access controls, digital keypads, smaller manual pull stations, shutdown switches in computer rooms, workshops and many more. It offers excellent protection against physical damage (both accidental and intentional), dust and grime as well as severe environments inside and out. The Mini Stopper II consists of a clear,

tamper-proof, tough polycarbonate cover and frame that fits over the protected unit. When lifted to gain access to the protected unit, its optional battery powered alarm emits a piercing 120 dB. Immediate attention is drawn to the area and a prankster will either run or be caught. With gaskets, Mini Weather Stopper® can dramatically extend the life of equipment mounted in saltwater areas or areas requiring frequent hosing down.

## FEATURES

- Protects against vandalism, accidental damage, dust and grime as well as severe environments inside and outside.
- Mini Weather Stopper dramatically extends the lifespan of devices in saltwater areas.
- Fast, easy installation.
- Available with or without 120 dB horn.
- Weatherproofing available with a choice of gaskets.
- Cover is molded from thick, super tough polycarbonate material.
- Lifetime guarantee against breakage of polycarbonate cover (one year on electronic components).
- Perfect for protecting shutdown switches in computer rooms and workshops as well as other push button units.
- Available with red, green, blue or yellow label housing.
- Matching spacer available for surface units.
- Polycarbonate tested -40°F (-40°C) to 120°F (49°C).

# Mini Stopper® Mini Weather Stopper®

## Dimensions and Technical Information

Models Available

<b>STI-6500</b>	Clear cover for flush mounting.
<b>STI-6505</b>	Clear cover, shipped with spacer for surface mounting.
<b>STI-6510</b>	Clear cover for flush mounting, lockable.
<b>STI-6515</b>	Stopper Seal tamper resistant accessory for use with Mini Stopper.
<b>STI-6525</b>	Weather resistant version of the STI-6540 for flush mount applications.
<b>STI-6535</b>	Weather resistant version of STI-6545. Includes all necessary gaskets and a conduit spacer for surface mount applications.
<b>STI-6540</b>	Mini Stopper II without horn - with horn housing shell.
<b>STI-6545</b>	Mini Stopper II without horn, with spacer and horn housing shell.
<b>STI-6600</b>	Mini Stopper II with horn for flush mounting.
<b>STI-6605</b>	Mini Stopper II with horn and spacer for surface mounting.
<b>STI-6610</b>	Mini Stopper II with horn for flush mounting, lockable.

STI Fire Protection

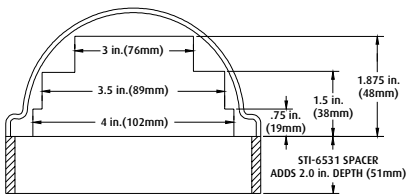

DEPTH CHART FOR MINI STOPPER  
AND CONDUIT SPACER

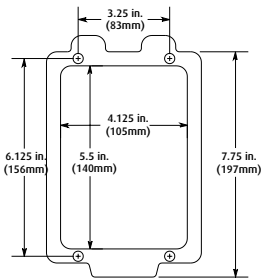

FRONT VIEW

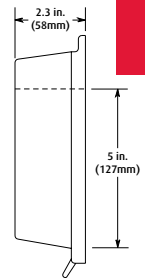

SIDE VIEW

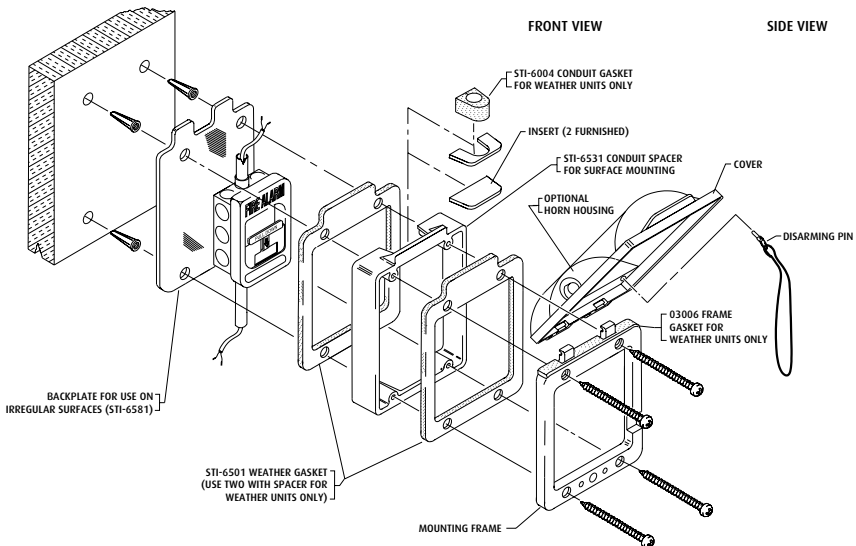



Accepted by fire marshals, these versions of the world famous STI Stopper® II are designed for areas where a "break glass" cover is specified, such as unsupervised areas. Each device consists of a red polycarbonate cover, mounting frame, a pane of single strength glass (easily replaced when broken), a glass breaking metal bar and anchors for installation. Two models are available for fire, the smaller STI-6100 and the larger STI-4100.

A spacer (STI-3100-R) is available for the STI-4100 to add 2" depth in order to accommodate surface mounted conduit installations. A third "generic" model (STI-6700) is available to cover devices other than manual pull stations. The same size as the STI-6100, it includes a wall mount hanging clip for keys, etc. This model for non-fire applications simply says "BREAK GLASS".

## FEATURES

- Housing is molded of super tough polycarbonate material.
- Aesthetically appealing.
- Fire alarm remains clearly visible and accessible.
- Lifetime guarantee on polycarbonate housing against breakage and damage in normal usage.
- Fast, easy installation.
- Glass replacement is simple. (Suggestion: Order extra panes with each unit).
- Accepted by fire marshals.
- Polycarbonate tested -40°F (-40°C) to 120°F (49°C).



## Dimensions and Technical Information

Models Available

<b>STI-4100</b>	Larger size Break Glass Stopper.
<b>STI-6100</b>	Standard size Break Glass Stopper.
<b>STI-6700</b>	Generic Break Glass Stopper.
<b>STI-3100-R</b>	Conduit Spacer (red) for STI-4100.
<b>SUB-08</b>	Replacement Break Glass Tool.
<b>SUB-09</b>	Replacement Glass for STI-6100.
<b>SUB-10</b>	Replacement Glass for STI-4100.
<b>SUB-67</b>	Replacement Glass for STI-6700 reads "Break Glass".
<b>STI-6702</b>	Tamperproof Screw Kit.
<b>STI-1280</b>	Backplate for STI-4100.

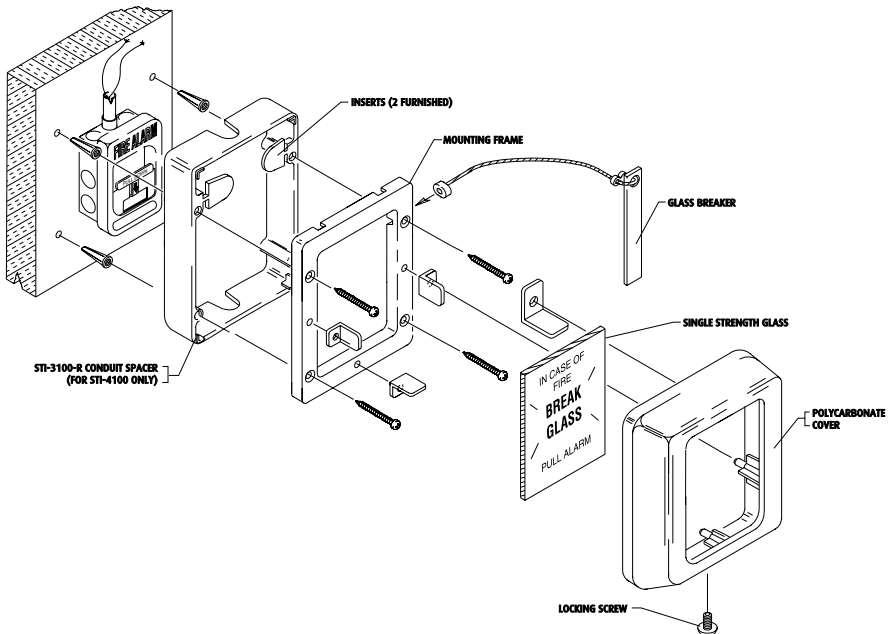
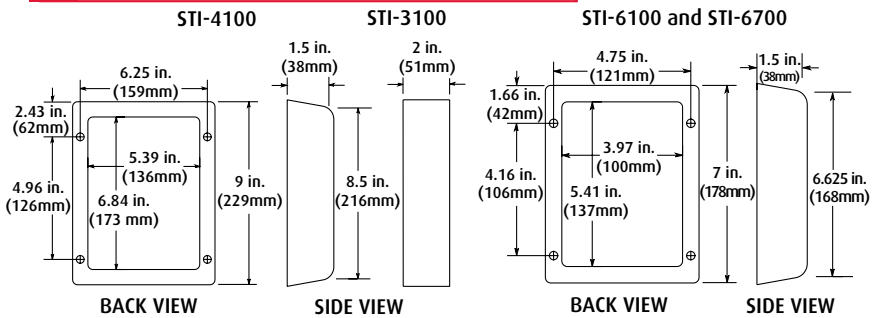

# NEMA 4X Stopper® Dome with Heater

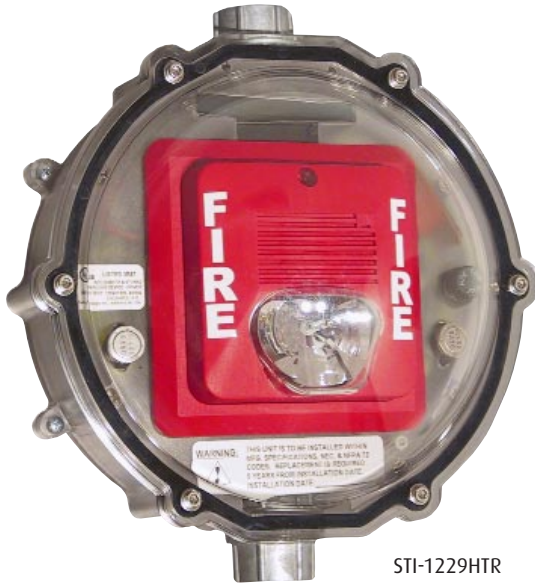

STI-1229HTR



Certain Models Only

**NEMA 4X**

**ADA**  
Compliant

Now there is a way to protect your signaling device located where temperature or environmental conditions exceed the suggested operation range. This protective cover with heater assembly for strobe appliances, is UL/cUL Listed to NEMA 4X Standards. Thermostatically controlled heater and a

continuous duty fan maintain a uniform temperature in the cover when located in a cold environment. Applications include, but are not limited to, refrigerators, freezers, meat packaging plants, arctic environments, ocean rigs, slaughter houses, etc. UL/cUL Listed down to -70°F (-57°C).

## FEATURES

- Maintains operating strobe appliance temperature with external temperatures to -70°F (-57°C).
- For use in areas where temperature or environmental conditions exceed the operational range of fire strobe signaling devices.
- Protects ADA compliant strobes to UL 1971 Standards.
- cUL Listing is for UL 1638 strobes only.
- Enables ADA compliant for visual fire protection systems where freezing temperatures or other harsh conditions exceed the operating limits of strobe signal devices.
- Enclosure rated to NEMA 4X Standards. Heater assembly rated to -70°F (-57°C).
- Prevents build up of snow on the unit or entry of moisture in wash down areas to assure that strobes remain clearly visible.
- Fan runs continuously to maintain a uniform temperature inside the enclosure.
- Heater units cycle as required to maintain the correct range of operating temperatures.
- The thick, clear polycarbonate cover is UV-stabilized against discoloration.
- Polycarbonate backed by a lifetime warranty against breakage in normal use, one year on electronics.
- CSFM requires local approval only.

# NEMA 4X Stopper® Dome with Heater

## Dimensions and Technical Information

Models Available

**STI-1229HTR** NEMA 4X Stopper® Dome with Heater.  
**STI-HK2** Replacement heater for STI-1229HTR.

### STI-1229HTR Typical Test Results

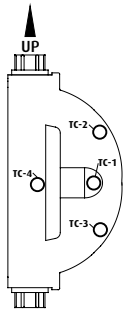

Test Probe Locations

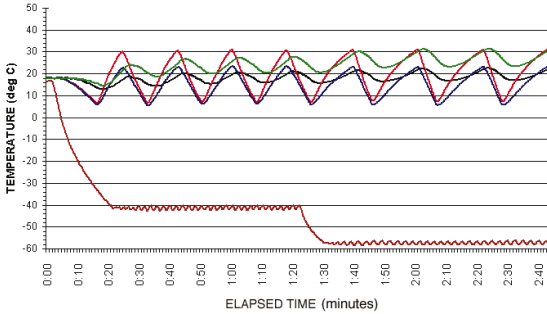

TC = Thermocouple

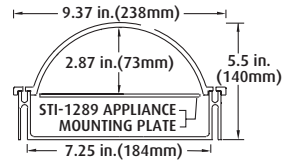

PRODUCT DIMENSIONS

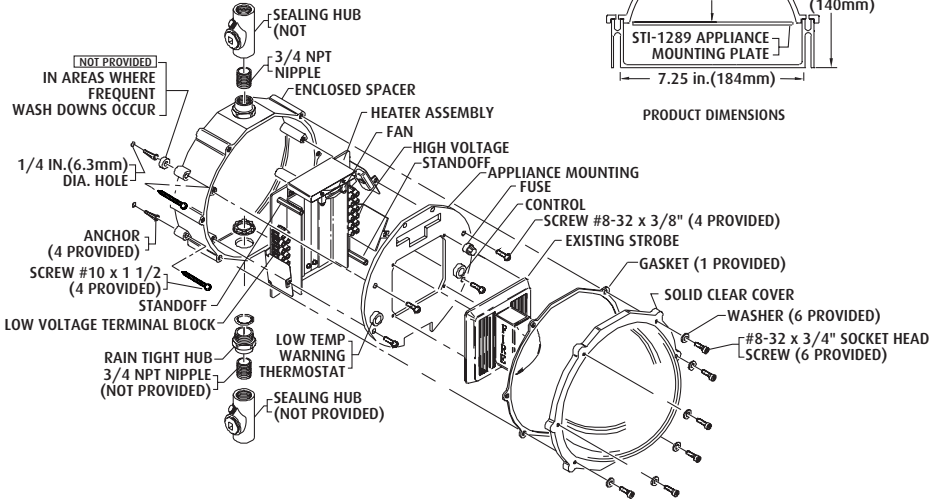



STI-1215



STI-1217



STI-1225



STI-1227



These virtually indestructible covers (slotted for horn or speaker units and solid for strobe only alarms) are designed to stop vandalism and accidental damage. Molded of clear, thick, UV-stabilized polycarbonate material, they are backed by a lifetime guarantee against breakage in normal use. Slots in the STI-1215, STI-1217 and STI-1219 allow the horn to be heard. STI-1225, STI-1227 and STI-1229 are for

strobes only. Several tough, clear spacers are available for larger strobe/horn units, retrofits, surface mount and an enclosed backbox for weather resistant applications. An appliance mounting plate comes with the STI-1219/STI-1229 and eliminates the need for an electrical backbox. Unique Enviro Kits are available for extreme conditions where dampness, water or dust are present.

## FEATURES

- Helps prevent accidental and intentional damage or vandalism to horn/strobe units.
- Lifetime guarantee against breakage in normal use.
- Easy access for service.
- Enviro Kit available for extreme conditions.
- UV-stabilized against discoloration.
- Several spacers are available to accommodate special applications.
- Contact STI for light and sound loss information.
- Polycarbonate tested -40°F (-40°C) to 120°F (49°C).
- See STI-1229 for NEMA 4X cover or STI-1229HTR for NEMA 4X cover with heater.

## Dimensions and Technical Information

Models Available

- STI-1215** Horn/Speaker/Strobe protective cover for flush mount applications.
- STI-1217** Horn/Speaker/Strobe protective cover for surface mount applications.
- STI-1219** Horn/Speaker/Strobe cover with enclosed backbox.
- STI-1225** Strobe protective cover for flush mount applications.
- STI-1227** Strobe protective cover for surface mount applications.
- STI-1229** NEMA 4X weatherproof strobe cover. Spacer kit.
- SUB-123** Enviro Kit includes three gaskets and mounting hardware.

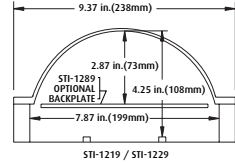
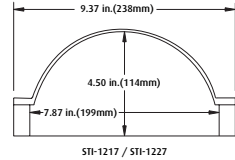
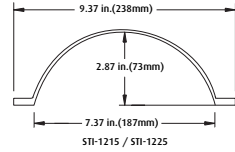

STOPPER DOME DIMENSIONS

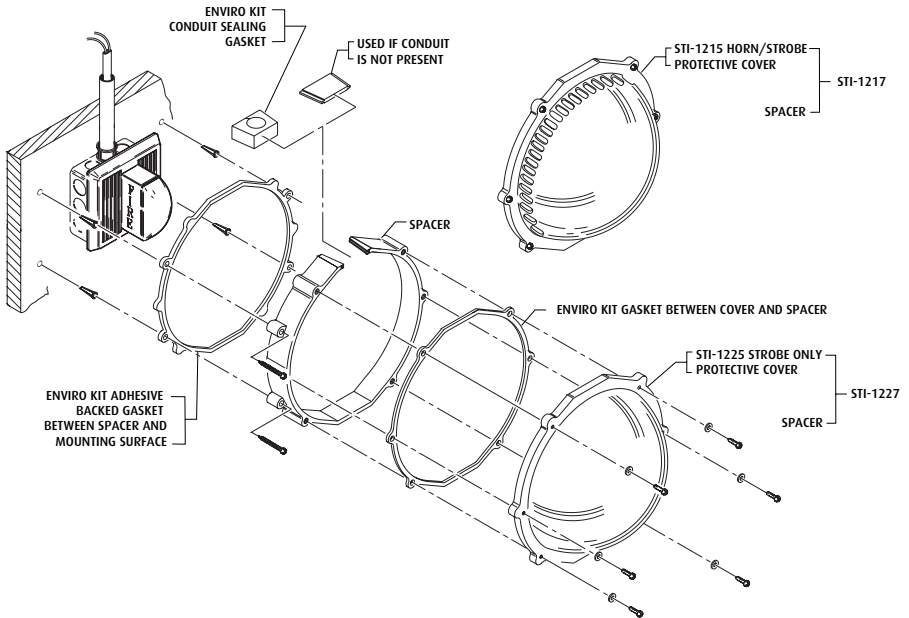

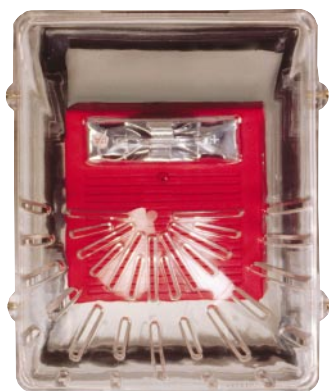

STI-1210E



STI-1221E



These virtually indestructible covers (slotted for horn or speaker units and solid for strobe only alarms) are designed to stop vandalism and accidental damage. Molded of clear, thick, UV-stabilized polycarbonate material, they are backed by a lifetime guarantee against breakage in normal use. Slots in the STI-1210 B, C, D and E models allow the horn to be heard. STI-1221 B, C, D and E models are for strobes only. Many tough, clear spacers are available for larger strobe/horn units, retrofits, surface mount and weather resistant applications. For the STI-1210/1221

series, spacer B has a solid back and is molded with an integral double-gang outlet box. Spacer C has an open back for retrofit applications. Spacer D accommodates deeper units and applications with exposed conduit electrical connections. When not specified, units are sent with Spacer E, an open back frame for flush-mount applications. An appliance mounting plate comes with the STI-1219/STI-1229. Unique Enviro Kits are available for extreme conditions where dampness, water or dust are present.

## FEATURES

- They help prevent accidental and intentional damage or vandalism.
- Easy access for service.
- Enviro Kit available for extreme conditions.
- UV-stabilized against discoloration.
- See STI-1229 for NEMA 4X cover or STI-1229HTR for NEMA 4X cover with heater.
- Many spacer sizes are available to accommodate special applications.
- Contact STI for light and sound loss information.
- Polycarbonate tested -40°F (-40°C) to 120°F (49°C).
- Lifetime guarantee against breakage in normal use.

## Dimensions and Technical Information

Models Available

- STI-1210B** Horn/Strobe with solid enclosed backbox and double gang outlet box.
- STI-1210C** Horn/Strobe with open back box.
- STI-1210D** Horn/Strobe for surface mount applications.
- STI-1210E** Horn/Strobe with open back frame for flush mount applications.
- STI-1221B** Strobe with solid enclosed backbox and double gang outlet box.
- STI-1221C** Strobe with open back box.
- STI-1221D** Strobe for surface mount applications.
- STI-1221E** Strobe with open back frame for flush mount applications.
- SUB-121** Enviro Kit for D and E models.
- SUB-122** Enviro Kit for B and C models.
- SUB-06297D** "D" spacer only.
- SUB-06297E** "E" spacer only.

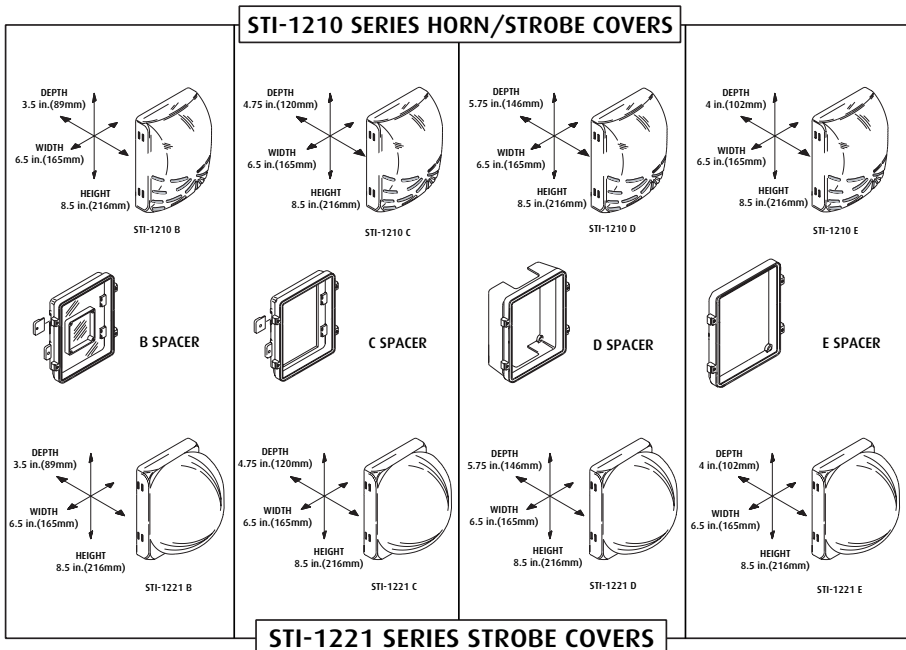

Call us for additional literature  
Visit us at

**www.STOPPER.com**

**800-888-4STI**



*"We protect the things that protect you."*

Safety Technology International, Inc.

2306 Airport Road, Waterford, Michigan 48327

Phone: 248-673-9898 Fax: 248-673-1246

Email: [info@stopper.com](mailto:info@stopper.com) Web: [www.stopper.com](http://www.stopper.com)

Safety Technology International, (Europe) Ltd.

Unit 3 Olton Wharf, Richmond Rd., Olton, Solihull, Eng. B92 7RN

Telephone: 44 (0) 121 707 2999 Facsimile: 44 (0) 121 707 8999

Email: [info@sti-europe.com](mailto:info@sti-europe.com) Web: [www.sti-europe.com](http://www.sti-europe.com)